

**SPOTLIGHT: CORDERA**

CONTINUED FROM PAGE 1

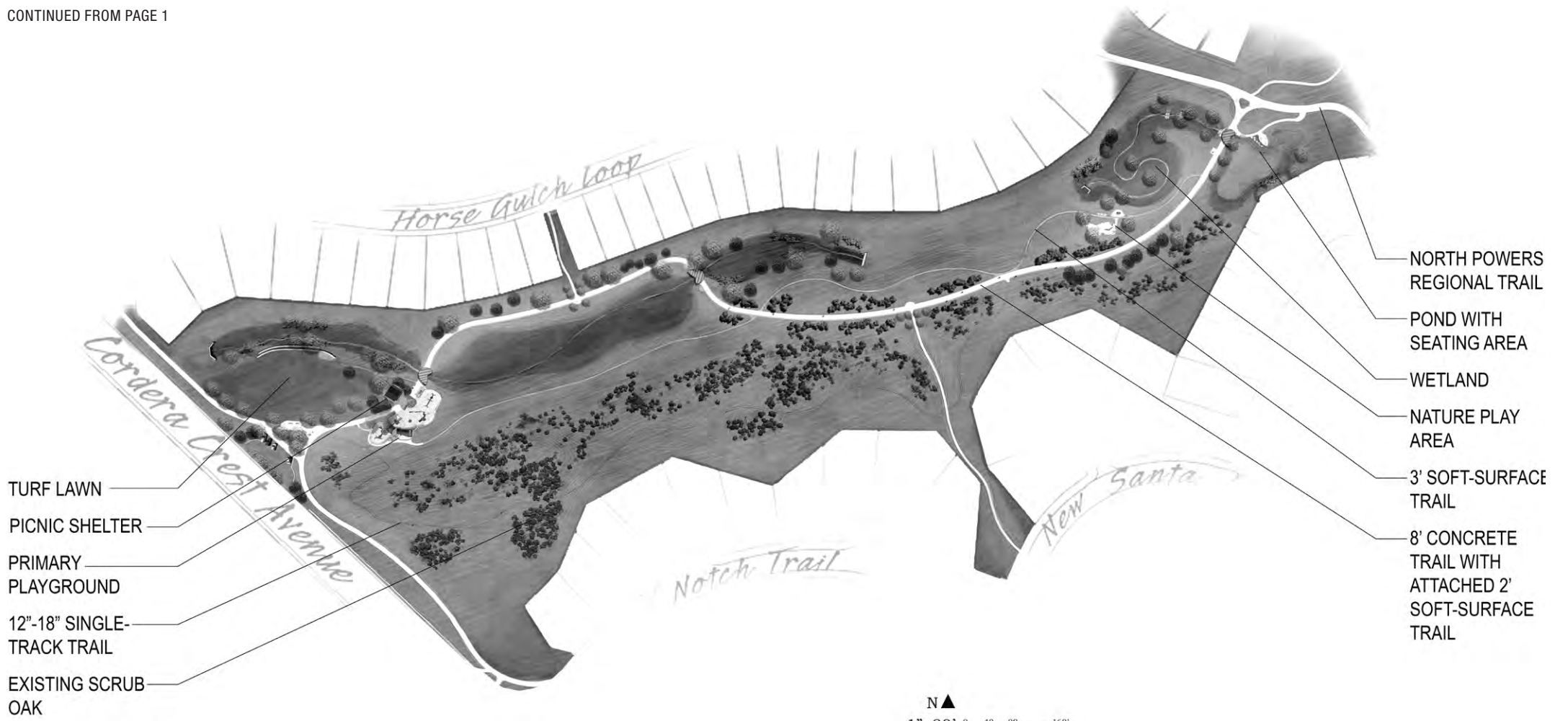

feel the theme is a great fit with the natural terrain, and a catalyst for the type of imaginative play that they'd like to encourage in the community's children. Similar to Max's journey from his bedroom to an island inhabited by fantastic creatures, children will simply leave their nearby homes to enjoy the natural beauty and sense of discovery the park will inspire.

Set to open at the end of this coming summer, the 16-acre park follows more recent design trends that have begun to move away from standardized play and more toward unstructured play. The design also incorporates modern trends that aim to utilize the site's natural assets and systems. It is the perfect reflection on Max's wild flight of imagination that occurs in the book. The design is also unique in providing play areas throughout the acreage of the park, rather than having the amusements contained to one designated "playground" area.

Some of the most impressive aspects are the creative features that reference back to images from the book. For example, boardwalk crossings over a natural drainage channel that runs through the site will be made to look like the leaves in the trees illustrated throughout the book. Stamped concrete "Monster Footprints" will appear in areas. Located at the western entrance to the park will be a crown and scepter

sculpture created by a local artist, that looks just like the crown and scepter Max wore on his imaginary island. The natural play area will encourage children to let their imaginations run wild, as Max's did in the story.

Wild Rumpus Park will also aim to highlight the site's incredible natural beauty and character, with opportunities to explore and enjoy mature existing vegetation, rolling topography and vast views of Pikes Peak. A variety of amenities such as age-targeted, traditional, and natural play areas are planned for the park to encourage discovery.

This Nature Play/Discovery Area will provide natural obstacles for users to climb, crawl and balance on — elements such as boulders, logs and sand — that will encourage unstructured play. All good features for any aspiring "King of the Wild Things" working on their monster-taming skills.

La Plata Communities, the developer of Cordera, believes that this park will not only be an outstanding lifestyle amenity for community residents, but they also expect it to increase and maintain the values of the adjacent homes in Cordera, while continuing to enhance the quality of life for all residents. It will truly be unlike any other park in the region. So, as Max says in the story, "Let the wild rumpus start!"

Visit [cordera.com](http://cordera.com) for more information.



Stamped concrete "Monster Footprints" will appear in areas. Located at the western entrance to the park will be a crown and scepter sculpture created by a local artist, that looks just like the crown and scepter Max wore on his imaginary island.



## 2019 St. Jude Dream Home ribbon cutting took place May 3, tickets on sale now

NEWSWIRE

The ribbon cutting for the 2019 St. Jude Dream Home located at 8723 Tranquil Knoll Lane was celebrated on May 3, and the home is now open for viewing. You can tour the home every Saturday from 9 a.m. to 5 p.m. and Sunday from noon to 5 p.m., through June 9. And, as an added bonus, everyone who visits the home can enter to win a \$10,000 shopping spree from Furniture Row. Tickets are now on sale; only 9,000 tickets will be sold, and the winner will be announced on KKTU News on June 14.

Each year Covington Homes and their trade partners donate 100% of the materials and labor to build a beautiful home to benefit the St. Jude Children's Research Hospital. For the third year in a row, Covington Homes has built the Colorado Springs St. Jude Dream Home at zero cost. This means that all of the proceeds from the ticket sales will go directly to St. Jude Children's Research Hospital. Every dollar helps children such as Caylee — their featured local St. Jude former patient and cancer survivor — live long and beautiful lives.

Once again, this year's St. Jude Dream home is being built in the spectacular community of Banning Lewis Ranch. The beautiful wide-open

ranch floor plan — The Palazzo — won the People's Choice award in the 2018 Parade of Homes.

With incredible upgrades, beautiful finishes, impeccable interior design and a value of over \$565,000, the winner of this Dream Home will have won a true treasure. The approximately 3,700-square-foot, garden-level home will have a finished basement, five bedrooms, four bathrooms, and a gourmet kitchen with granite countertops, designer cabinetry, a large island, butler's pantry and stainless steel appliance package.

Covington Homes and St. Jude ALSAC, together with their trade partners, business partners and community members, have raised over \$2.6 million for the St. Jude Children's Research Hospital over the past three years, and they are working towards a goal of over \$3.5 million raised over the past four years of the Dream Home campaign.

There's not much time left to get your St. Jude Dream Home ticket, and more prizes can be won for buying early. Get yours today at [www.dreamhome.org](http://www.dreamhome.org) — you could win a home, and you'll be helping to fight childhood cancer. ■

